

NewRefLED Luminaire with joint arm



DESCRIPTION:

The NewRefLED luminaire is suitable for local lighting and is recommended as a replacement for older halogen luminaires with an input power of 150W. The luminaire body is made of extruded aluminum profile, fitted with one LED chip and complemented by an aspherical glass lens with a peak angle of 40°. The sealing of the luminaire is guaranteed by the IP69 protection rating (100 bar water jet) in the version without a switch. If the luminaire is equipped with a rocker switch (code RV7) on the head, the overall degree of protection is IP67.

Inside the luminaire is a switched power supply that provides constant current power to the LEDs over a range of supply voltages from 10 to 48 VDC or 12 to 35 VAC. If you do not have a low voltage power supply on your machine, you will find suitable power supplies in the Accessories and Spare Parts section.

The luminaire is attached with a joint arm, finished with a metal stand with four screw holes. The cable outlet from the stand is either through the bottom or through a gland on the side of the stand. The fixing can be supplemented at extra cost with a switchable magnetic holder or plate clamp.

TECHNICAL PARAMETERS:

- Supply voltage 11 to 48 V DC, 12 to 35 V AC
- Consumption 22 W
- Light source Cree CMA1825 Ra=80
- Luminous flux 3500 lm
- Minimal lifetime 80 000 h
- Ingress protection IP69 (with the switch IP67)
- Ambient operating temperature -20 to +50°C

ADVANTGES:

- Minimal workpiece heating
- Small dimensions of the luminaire, allowing to place the luminaire close to the illuminated object
- Shock and vibration resistant
- Robust articulated arm with large extension and high braking force
- High ingress protection up to IP69 (water jet 100bar)
- Good color rendering
- The service life of the luminaire is at least 80 000 hours
- Return compared to a 150W halogen lamp approx. 2 months (lit 16 hours a day)

DIMENSIONS:

- Luminary body diameter 97 mm
- Luminary body length 100 mm
- Stand height 46 mm
- Standard arm length 400 mm

Luminaire mounting drawing:

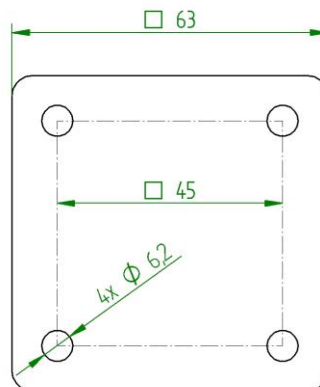

Order Code	Beam angle of the lens	Outlet
NewRefLED/KX1/40D	40°	Cable gland
NewRefLED/KX0/40D	40°	Bottom of the stand
NewRefLED/RV7/KX1/40D	40°	Cable gland
NewRefLED/RV7/KX0/40D	40°	Bottom of the stand

LUMINOSITY CURVES:

